Command Exercise

Exercise 11-3 – Converting Existing Dimensions to Annotative

Drawing Name: **nlayout3.dwg**
Estimated Time to Completion: 20 Minutes

Scope

Change existing dimensions to annotative, so that they can use Annotative Scale.

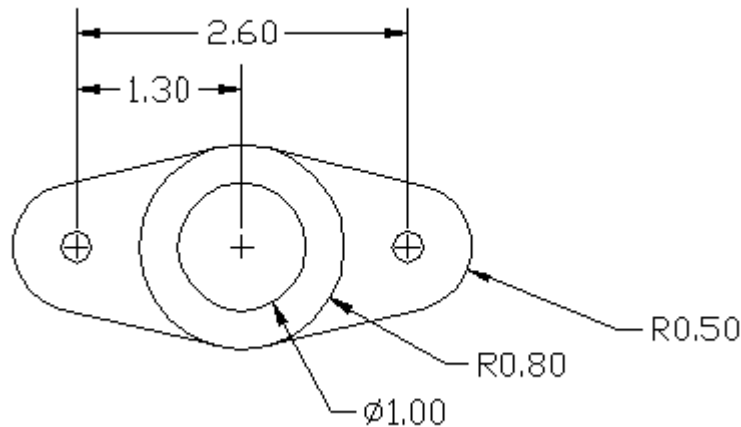
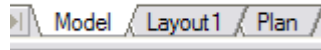
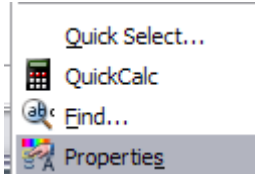

Figure 6 – Converting Existing Dimensions to Annotative

Solution

1. Verify that the Model tab is active.



2.  Select the 2.60 dimension so it is highlighted. RMB and select **Properties**.

3.  Expand the **Misc** category. Set Annotative to **Yes**.

4.  The Annotative scale field appears.
Select the ... button.

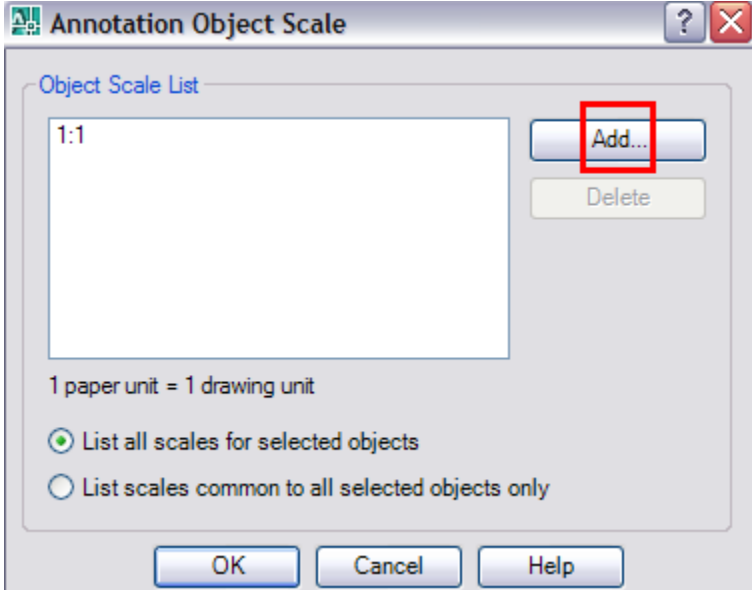
5.  Select the **Add** button.

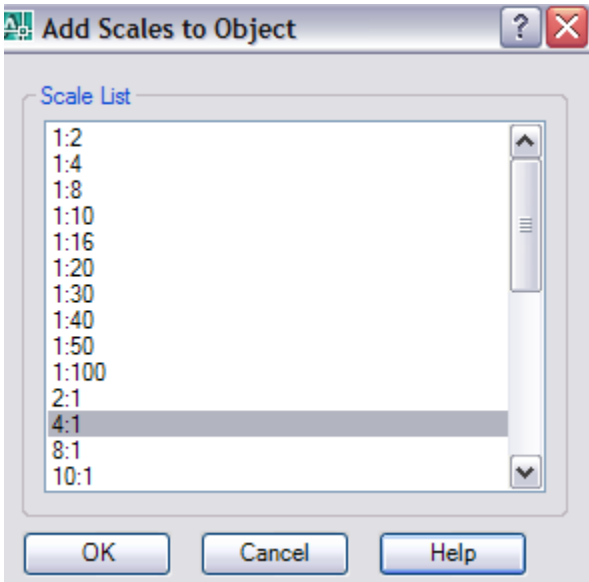
6.  The 3:1 scale we assigned to the viewport does not exist in the list.
Press **Cancel**.

7. Press **Cancel** to exist the Annotation Object Scale dialog.
8. Type **scalelistedit** on the command line.

| `scalelistedit`

TIP: If you press the **TAB** key after you type the first two letters, AutoCAD will fill in the rest.

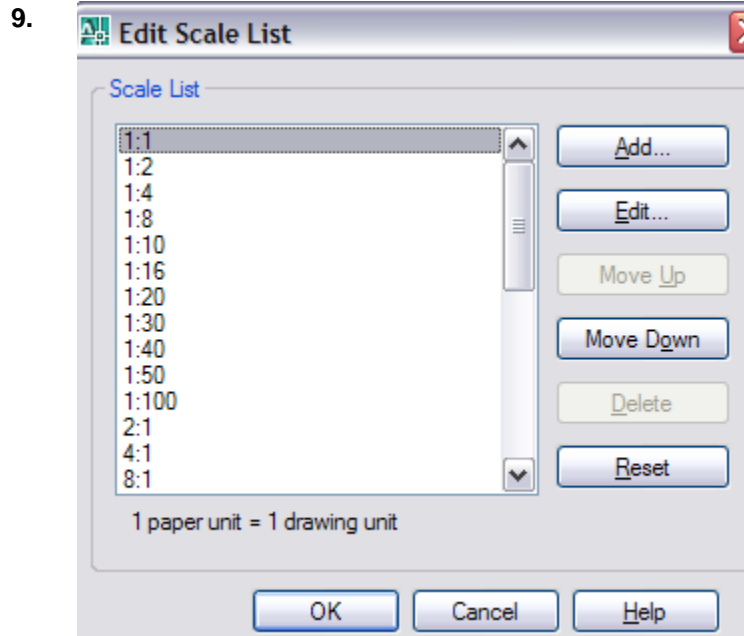

The list of available scales is shown.

Press the **Add** button.

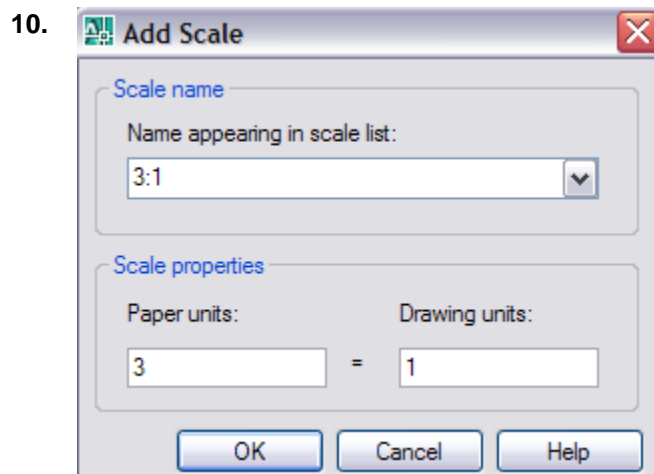

Type **3:1** in the Scale name field.

Set the Paper units to **3**.

Press **OK**.

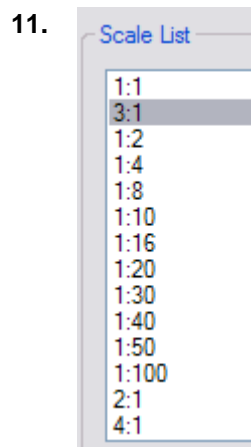

3:1 appears in the list.

Use the Move Up and Move Down buttons to position the new scale in the correct location.

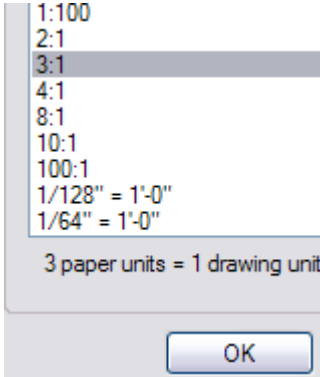
12.  Press **OK**.

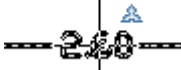
13.  Note when you mouse over the 2.60 dimension, a small icon now appears indicating that it is an annotative dimension.

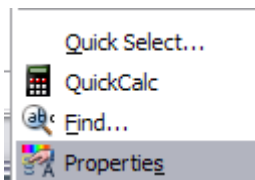
14.  Select the 2.60 dimension so it is highlighted.
RMB and select **Properties**.

15.  Select the ... button in the Annotative scale field.

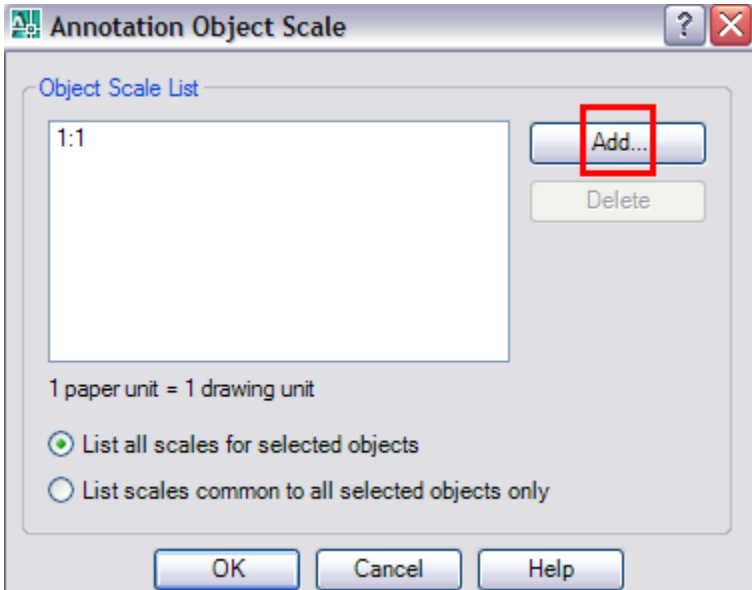
16.  Select the **Add** button.

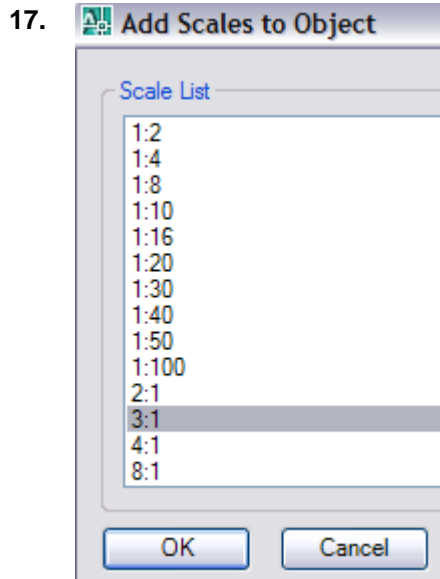

The **3:1** scale is now included in the list.

Highlight this scale and press **OK**.

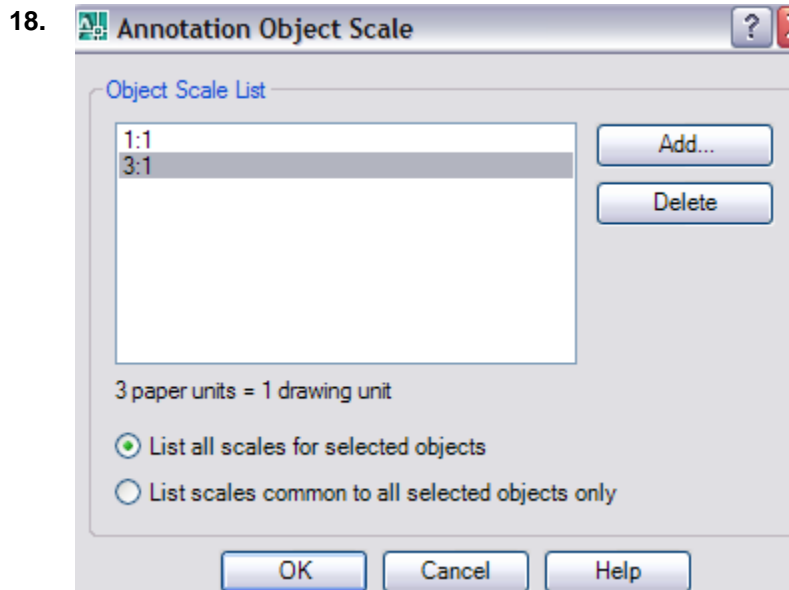

The **3:1** scale is now available for the dimension.

Press **OK**.

19. Set the remaining dimensions to Annotative and assign the 3:1 scale to them.

You can select all the dimensions and set them to be Annotative using Properties, but in order to add the 3:1 scale, each dimension must be set individually.



Note when you mouse over the dimensions, the Annotative icon now shows that more than one Annotative scale is available.

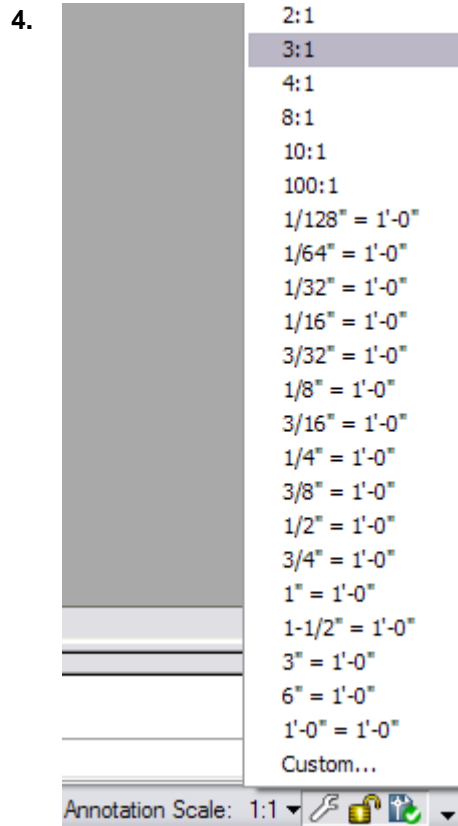

Left click on the down arrow next to the Annotation Scale and you will see the list of scales available.

Select **3:1**.

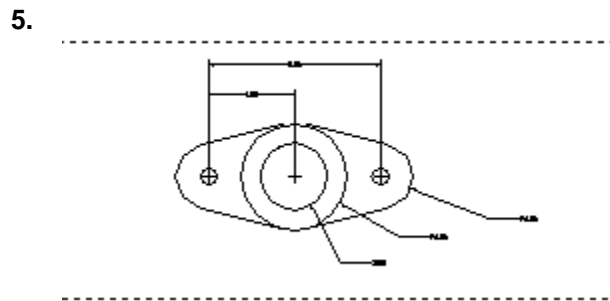

Filename: annoscales.doc
Directory: C:\tutorials
Template: C:\Documents and Settings\Elise Moss\Application
Data\Microsoft\Templates\Normal.dot
Title: Command Exercise
Subject:
Author: elise moss
Keywords:
Comments:
Creation Date: 12/26/2006 12:23 PM
Change Number: 1
Last Saved On: 12/26/2006 12:25 PM
Last Saved By: elise moss
Total Editing Time: 2 Minutes
Last Printed On: 12/26/2006 12:27 PM
As of Last Complete Printing
Number of Pages: 7
Number of Words: 451 (approx.)
Number of Characters: 2,121 (approx.)